

Procedures are stored sets of commands that can be named and then run at any time to save you writing the same instructions over and over again.

Open the keypad on green level
Draw a square by pressing the sequence, Repeat 4, forward 20, left 90, End.
Press the save button



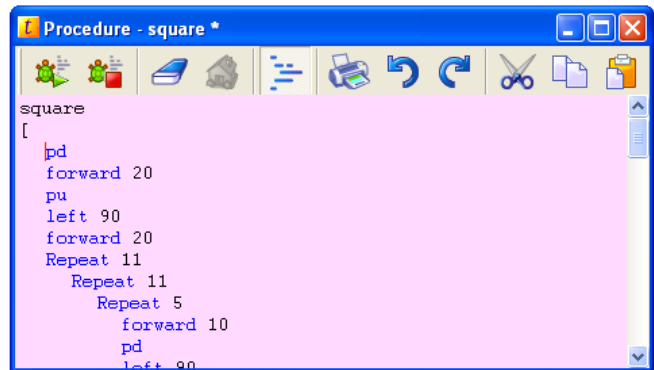
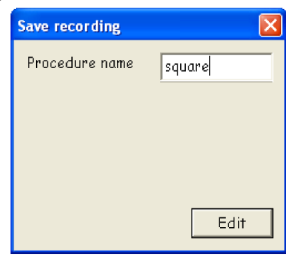

Type the procedure name square into the window that opens.

Press Edit

This window will open displaying the procedure you have just created.



The procedure square can be run in many ways

1. By pressing the Run button on the procedure editor window 
2. By typing square on the page, and pressing the Run button on the button bar 
3. By typing square on the command line in the Command Window 
4. By selecting an object and using the Links window , set the logo command to square

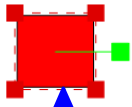
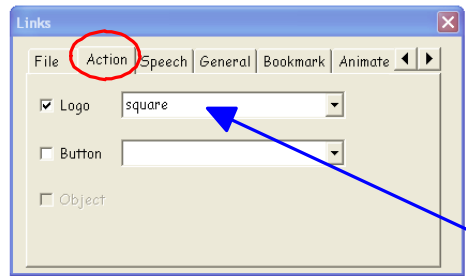

An object is selected

Type 'square' here

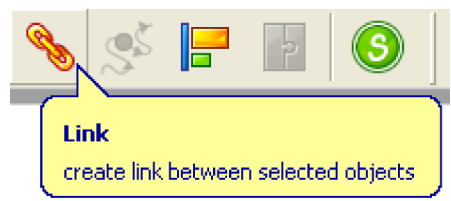

The object will become a button. Every time it is clicked the Turtle will create a square. You can also type other logo commands. The drop down arrow has suggestions.

5. By having the word square as part of the body of other procedures